

PXI and PXI Express Chassis Fan Replacement

This guide describes how to replace the fan on a PXI or PXI Express chassis.



Caution Be sure to unplug the power cord before replacing the fan.



Caution Only trained service personnel should replace the fan.

4, 5, 6, and 9-Slot Chassis Fan Replacement



Note Only chassis with specific assembly numbers support fan replacement. The supported model numbers are listed below, followed by their supported assembly numbers in parentheses. The *x* denotes the assembly letter revision. Before replacing the fan, be sure to check the model and assembly numbers on the back of your PXI or PXI Express chassis. Replace the fan only if the model and assembly numbers are on the following list.

- PXI-1031 (190871*x*-01L, Revision L and newer)
- PXI-1033 (194918*x*-01L, Revision E and newer)
- PXI-1036 (192592*x*-01L, Revision H and newer)
- PXIe-1071 (195659*x*-01L)
- PXIe-1073 (196695*x*-01L, Revision D and newer)
- PXIe-1078 (199485*x*-0*x*L)
- PXIe-1083 (132028*x*-0*x*L)
- PXIe-1088 (141884*x*-0*x*L)

Figures 1 and 2 show the parts you must remove to access the fan.

Figure 1. 4, 5, and 6-Slot Chassis Part Locations (Chassis Shown Upside Down)

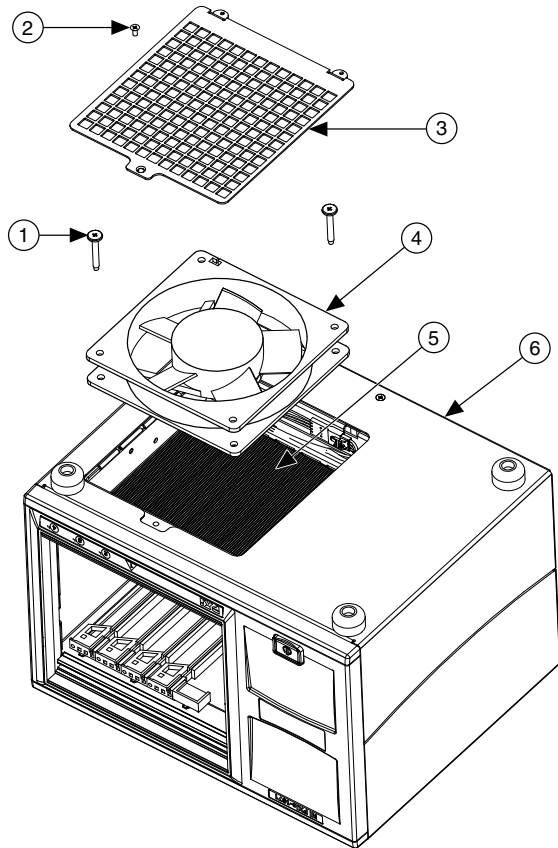

-
- | | |
|--------------------------------|---------------------------------|
| 1. Fan Shoulder Screw (x2) | 4. Fan |
| 2. Fan Access Panel Screw (x1) | 5. Screen (Visible Through Fan) |
| 3. Fan Access Panel | 6. Chassis |
-

Figure 2. 9-Slot Chassis Part Locations (Chassis Shown Upside Down)

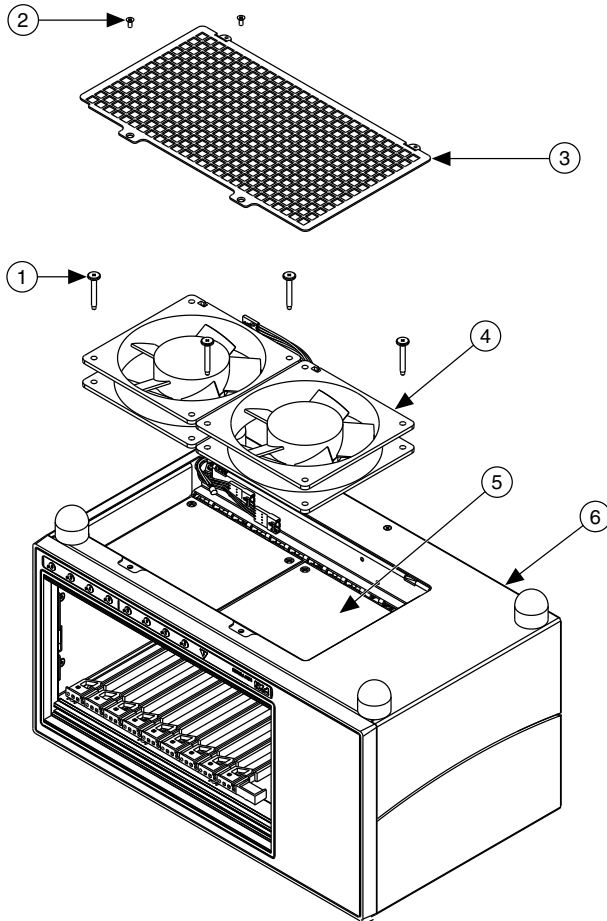

- | | |
|--------------------------------|---------------------------------|
| 1. Fan Shoulder Screw (x4) | 4. Fan (x2) |
| 2. Fan Access Panel Screw (x2) | 5. Screen (Visible Through Fan) |
| 3. Fan Access Panel | 6. Chassis |

Complete the following steps to replace the fan. (Refer to Figures 1 and 2 for parts locations.)

1. Locate the fan access panel on the bottom of the chassis. Remove the access panel screw and access panel.
2. Remove the fan shoulder screws, shown in Figures 1 and 2, that fasten the fan. Be careful not to lose the screws.
3. Remove the fan and screen.

4. Disconnect the fan cable from the inline connector. Figures 3 and 4 show the connector.

Figure 3. 4, 5, and 6-Slot Chassis Fan Cable Inline Connector

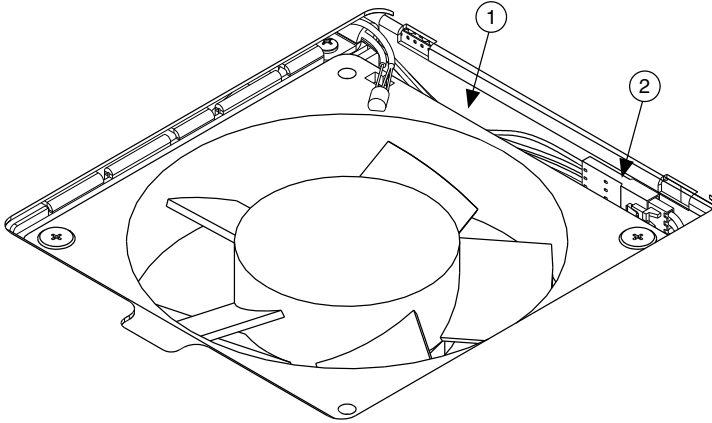

-
- 1. Fan
 - 2. Fan Cable Inline Connector
-

Figure 4. 9-Slot Chassis Fan Cable Inline Connector

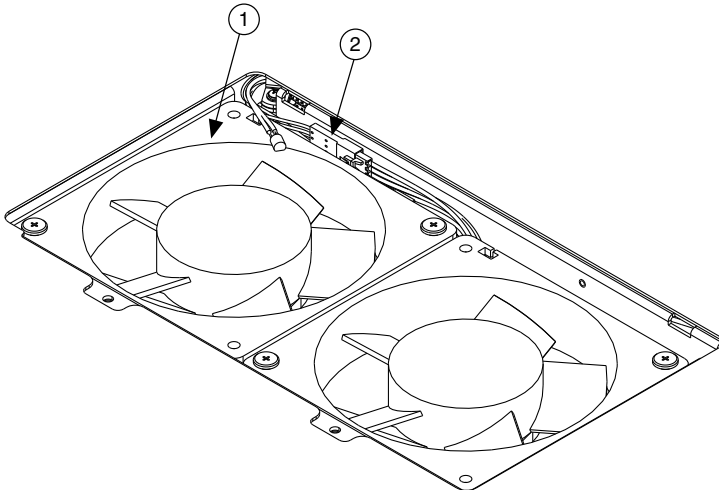

-
- 1. Fan
 - 2. Fan Cable Inline Connector
-

5. Place the screen below the new fan (refer to Figures 1 and 2 for screen location). Ensure that the loose screen doesn't fall out. If the screen does fall out, return it to its position under the fan.
6. Connect the new fan to the inline connector.
7. Place the new fan inside the fan bracket with the square slot oriented as shown in Figures 5 and 6. The air flow direction is into the chassis, so the plastic grill and label on the fan should face toward the PXI module cage.

Figure 5. 4, 5, and 6-Slot Chassis Square Slot on Fan Housing

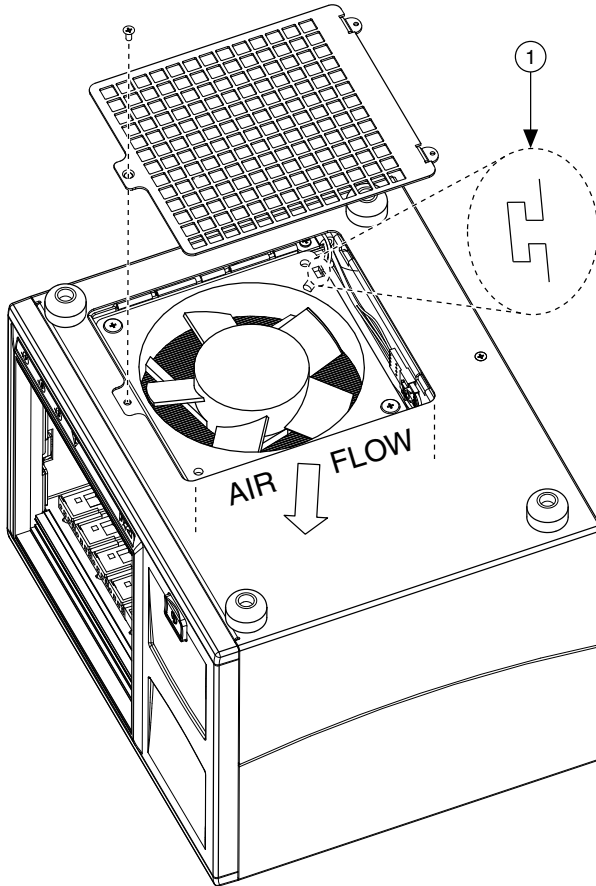

1. Square Slot on Fan Housing

Figure 6. 9-Slot Chassis Square Slot on Fan Housing

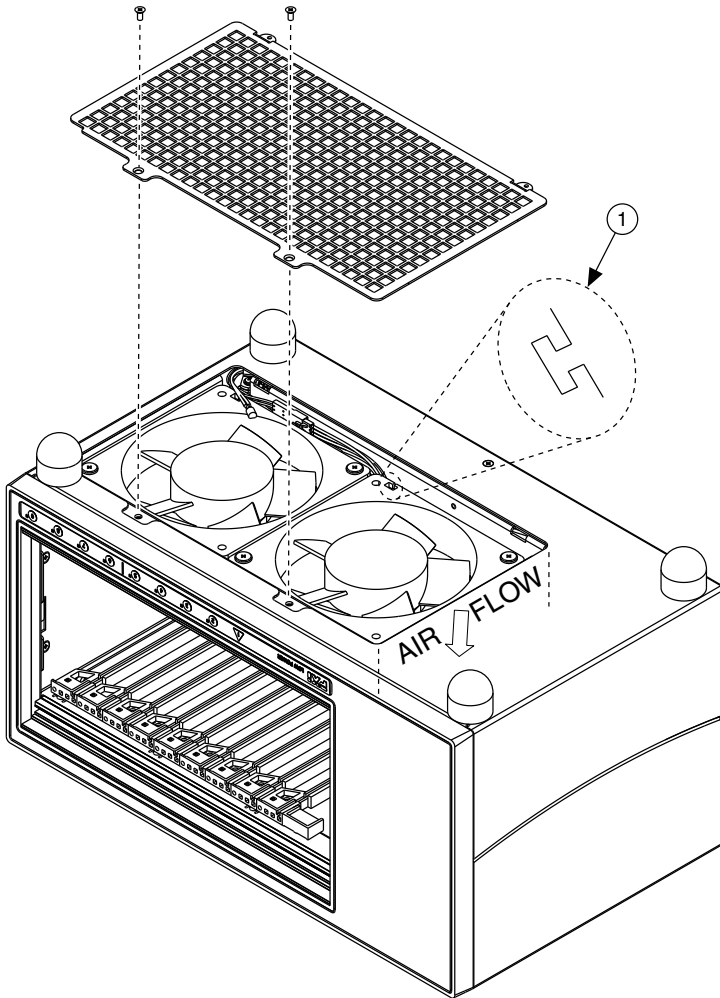

1. Square Slot on Fan Housing

- Reinstall the shoulder screws, tightening them to between 3.0 lb · in. minimum torque and 3.6 lb · in. maximum torque.
- Orient the thermistor wire as shown in Figures 7 and 8.

Figure 7. 4, 5, and 6-Slot Chassis Thermistor Wire

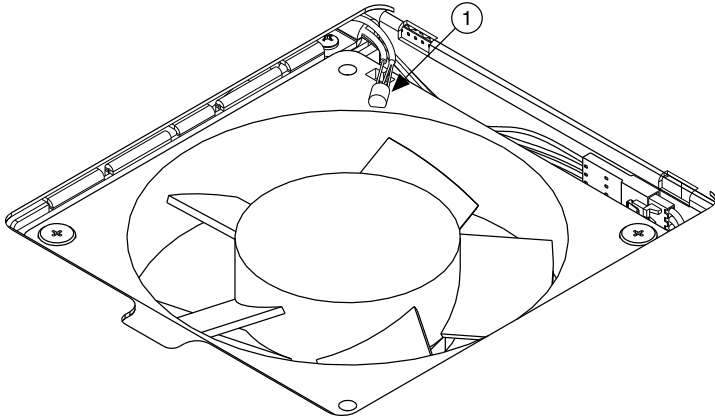

-
- Thermistor Wire
-

Figure 8. 9-Slot Chassis Thermistor Wire

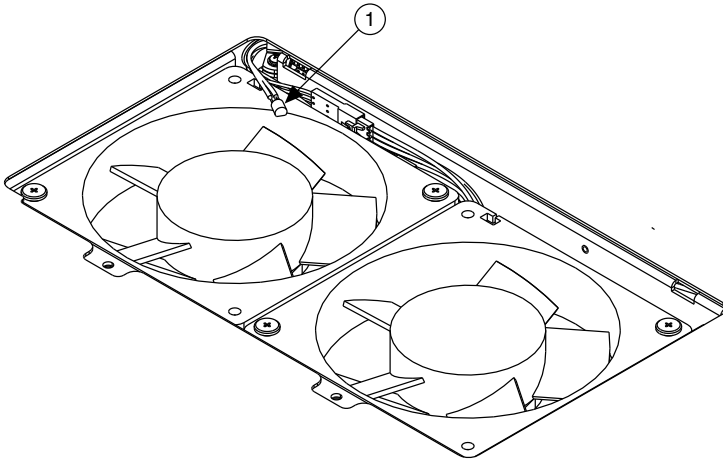

-
- Thermistor Wire
-

- Place the fan access panel over the opening. Insert and tighten the access panel screw(s) to between 3.0 lb · in. minimum torque and 3.6 lb · in. maximum torque.
- Reorient the chassis to an upright position and ensure there are no loose parts prior to plugging in the power cord.

Worldwide Support and Services

The NI website is your complete resource for technical support. At ni.com/support, you have access to everything from troubleshooting and application development self-help resources to email and phone assistance from NI Application Engineers.

Visit ni.com/services for information about the services NI offers.

Visit ni.com/register to register your NI product. Product registration facilitates technical support and ensures that you receive important information updates from NI.

NI corporate headquarters is located at 11500 North Mopac Expressway, Austin, Texas, 78759-3504, USA. For up-to-date contact information for your location, visit ni.com/contact.

Information is subject to change without notice. Refer to the *NI Trademarks and Logo Guidelines* at ni.com/trademarks for information on NI trademarks. Other product and company names mentioned herein are trademarks or trade names of their respective companies. For patents covering NI products/technology, refer to the appropriate location: **Help»Patents** in your software, the `patents.txt` file on your media, or the *National Instruments Patent Notice* at ni.com/patents. You can find information about end-user license agreements (EULAs) and third-party legal notices in the `readme` file for your NI product. Refer to the *Export Compliance Information* at ni.com/legal/export-compliance for the NI global trade compliance policy and how to obtain relevant HTS codes, ECCNs, and other import/export data. NI MAKES NO EXPRESS OR IMPLIED WARRANTIES AS TO THE ACCURACY OF THE INFORMATION CONTAINED HEREIN AND SHALL NOT BE LIABLE FOR ANY ERRORS. U.S. Government Customers: The data contained in this manual was developed at private expense and is subject to the applicable limited rights and restricted data rights as set forth in FAR 52.227-14, DFAR 252.227-7014, and DFAR 252.227-7015.

© 2011—2020 National Instruments Corporation. All rights reserved.

373597B-01 August 21, 2020